



The **EU Declaration of Conformity** is available in the download area of
 ASSA ABLOY
 Sicherheitstechnik GmbH
 Attilastr. 61 – 67
 12105 Berlin
 GERMANY
 Tel. + 49 30 8106-0
 berlin@assaabloy.com
www.assaabloy.com/de

Disposal

The following applies to products marked with the symbol  (crossed out dustbin):
 The applicable environmental protection regulations must be observed. Do not dispose of electrical devices in the household waste.

Packaging

Packaging materials must be recycled. You can also give packaging material to the distributor or trade professional for disposal free of charge at the place of handover.

Batteries



Li

Battery contains
Lithium

The product contains disposable or rechargeable batteries. Batteries must be removed from the product (see „Replacing the battery“) and disposed of separately.
 Used batteries should not go in household waste and can be returned to any local collection point free of charge. You are legally obliged to recycle used batteries.

Product



WEEE reg. no. DE 69404980
 You must dispose of the product correctly as electronic scrap after use and take it to a local collection point for recycling free of charge.

You have the following additional options for free disposal through the distributor:

- Return an old device with similar functions at the place where the new device is delivered.
- Return a maximum of three similar old appliances (max. edge lengths 25 cm) to a retail store with no obligation to purchase a new one.

The take-back obligation applies to distributors of electrical appliances with a sales area of over 400 m² or to distributors of foodstuffs that offer electrical appliances several times a calendar year or continuously with a total sales area of 800 m². In the case of online providers, the total storage and shipping areas for electrical appliances are considered retail space. For further details, see German Electrical and Electronic Equipment Act Section 17 (1)(2) [ElektroG § 17 (1)(2)].

Distributors using means of remote communication must, upon delivery, collect or take away free of charge heat exchangers, screens, monitors and devices containing screens with a surface area greater than 100 square centimetres and devices in which at least one of the external dimensions is greater than 50 centimetres. For lamps and smaller devices in particular, they must ensure suitable return options at a reasonable distance.

eCLIQ User instructions

N109

Please check the battery functionality regularly!

IKON
ASSA ABLOY

Experience a safer
and more open world

1. Your key is a high-quality electronic product. Protect the key from dirt and moisture.
2. Where malfunctions are due to wetness, only wipe the key dry.
3. On actuation of the cylinder, there is a release delay of **approx. 0.1 seconds**. If the battery is low, this delay can be 0.3 seconds.
4. Battery life:
User key 100,000 locking operations over approximately 10 years
Beluga key 20,000 locking operations,
 B1 = 7 years, B2/B3 = 5 years.
 The battery in the BELUGA version cannot be replaced.
5. Key ambient temperature: -30 °C to +50 °C
6. Key featuring 'ATEX=II 2G Ex ib IIC T4 Gb' for use in potentially explosive areas of Zone 1

 **II 2G Ex ib IIC T4 Gb**
 IBExU14ATEX1125X

The key sends signals as soon as it is inserted into the cylinder.

Comment	Acoustic signal	Visual signal
Normal state	-	-
Battery low, replace	3 x long	3 x long, green
Locking authorisation OK	1 x short	1 x short, green
Keine Schließberechtigung	3 x short	3 x short, red
No locking authorisation, because the key is currently outside of the time zone	3 x short	short, red - green - red
Update of authorisation (only relevant for CLIQ GO systems)	1 x short, 1 x long	1 x short green, 1 x long green

Classification of instructions



Danger!

Safety warning: Failure to observe these warnings will lead to death or serious injury.



Warning!

Safety warning: Failure to observe these warnings can lead to death or serious injury.



Attention!

Note: Failure to observe these warnings can lead to property damage and impair the function of the product.

Replacing the battery (See also illustrations)



Danger!

Explosion hazard: Use of unsuitable batteries may cause excessive heating.

· Only use the NV20 special battery for explosive environments. Other batteries are not ATEX approved.

Risk of poisoning: Poisonous chemicals may escape if batteries are not handled as intended.

- Keep batteries away from children.
- Avoid contact with skin, eyes and mucous membranes.
- In case of contact with battery fluid, the affected areas must be rinsed immediately with clean water.
- In case of contact with battery fluid or if a battery is swallowed, seek medical attention immediately.



Warning!

Explosion hazard, fire hazard: There is a risk of explosion and fire if batteries are not handled as intended. The battery must not be recharged. Do not throw batteries into fire, place on heat sources, expose to direct sunlight, short circuit, disassemble or force open!



Attention!

Malfunction: If the battery is inserted incorrectly, the key will not operate.

- When inserting a new battery, make sure that the polarity is correct.

Replace the battery within 30 seconds: The clock time stored in the key is retained for 30 seconds (only V=E2 and V=E3). We recommend updating the key on the programming device after replacing the battery.

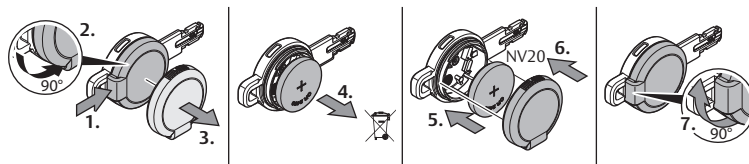

When batteries need replacing, they must be removed from the key as soon as possible and disposed of properly.

1. Press the locking tab on the cover and hold the locking tab down.
 2. Rotate the battery cover 90° anti-clockwise.
 3. Remove the cover.
 4. Note the orientation of the cover.
 - Remove the old battery.
 - Dispose of the battery according to regulations.
 5. Insert a new NV20 battery.
 6. Put the cover back with the same orientation as on removal.
 7. Turn the cover clockwise back to the initial position until it engages.
- ⇒ The replacement is complete.